



**SHEBOYGAN
CHRISTIAN
SCHOOL**

Scholarship | Discipleship | Citizenship



Building Hearts *and* Minds

Our Mission

Building Hearts and Minds



Ann Steenwyk
Director of
Academics and
Instruction

We are approaching the beginning of a new era at SCS – an era where 21st century school design will match 21st century instructional practices.

When our accreditation site team visited our campus in 2018, they commented that even though we had antiquated facilities, they were pleasantly surprised to find innovative instructional practices. Similarly, when giving tours to new families, we work hard to get families to look beyond

the worn out walls and into the classrooms where the “good stuff” happens. When I think about our new elementary school campus addition, I am overwhelmed by God’s faithfulness and provision for so many years in the Geele building and yet excited by the new beginnings that await.

Sheboygan Christian School already has all of the strong foundational elements of an excellent academic program that integrates biblical worldview to prepare our students’ hearts and minds for service in God’s world. The new campus facilities will allow us to do it in a more effective, innovative, and collaborative way.



Mission

IN PARTNERSHIP WITH THE CHRISTIAN COMMUNITY, SHEBOYGAN CHRISTIAN SCHOOL USES A BIBLICAL PERSPECTIVE TO INTEGRATE ACADEMIC EXCELLENCE WITH CHRIST-CENTERED LEARNING, PREPARING STUDENTS’ **HEARTS AND MINDS** FOR SERVICE IN GOD’S WORLD.

The new space will prepare students for real world team work. It will provide us more space for inquiry-based learning with room for larger and even messier, more complex projects. We are especially looking forward to larger spaces for corporate worship. And did we mention that it will be air conditioned?

While we revel daily in God’s goodness towards our school, we are now experiencing God’s rich abundance because of your generous and cheerful support. Thank you for your role in helping us to abound in this important and good work.



OUR VISION

- Unified P-12 Campus
- 21st century learning spaces
- Collaborative space
- Green space for all students
- Student Safety and Security
- Special education space
- Significant investment in athletics, arts, and worship

Taken from our Geele Campus, this cornerstone can be translated as, “The seed will serve him.” Since our founding in 1898, Sheboygan Christian School has looked to the future generations to proclaim God’s name. This building project is the next chapter in God’s story for the SCS community. We are the generation for which previous generations prayed. Today, we are investing in a space that will serve God’s people for generations to come.

“Posterity will serve him: future generations will be told about the Lord. They will proclaim his righteousness to a people yet unborn – for he has done it!”

—Psalm 22:30-31

The Plan

Building Hearts and Minds

As we consider our mission, we are excited to share this plan with you! We believe it will allow us to match our facility with our innovative educational practices.

When the elementary, middle, and high school unified in 2015, the goal to unify the physical campuses took on new energy as the board considered benefits for both students and staff. Professional learning communities PK-12 were established to develop curriculum and to share best practices knowing that when teachers and principals collaborate together at a higher level, student achievement rises.

Additionally, a unified campus with 21st century learning spaces creates opportunities for more acceleration/advanced learning as well as intervention for struggling students when needed. It facilitates opportunities for our high school students to build relationships and spiritually mentor our elementary and middle school students. Simply put, a unified campus creates more educational opportunities and a freedom to plan for learning rather than around scheduling. With this new freedom, the plan also provides for more green space, increased safety and security, special education services, and increased focus on athletics, arts, and worship.

We're nearly doubling the space at our 929 Greenfield campus!

*Current: 48,000 square feet
Future: 88,000 square feet*

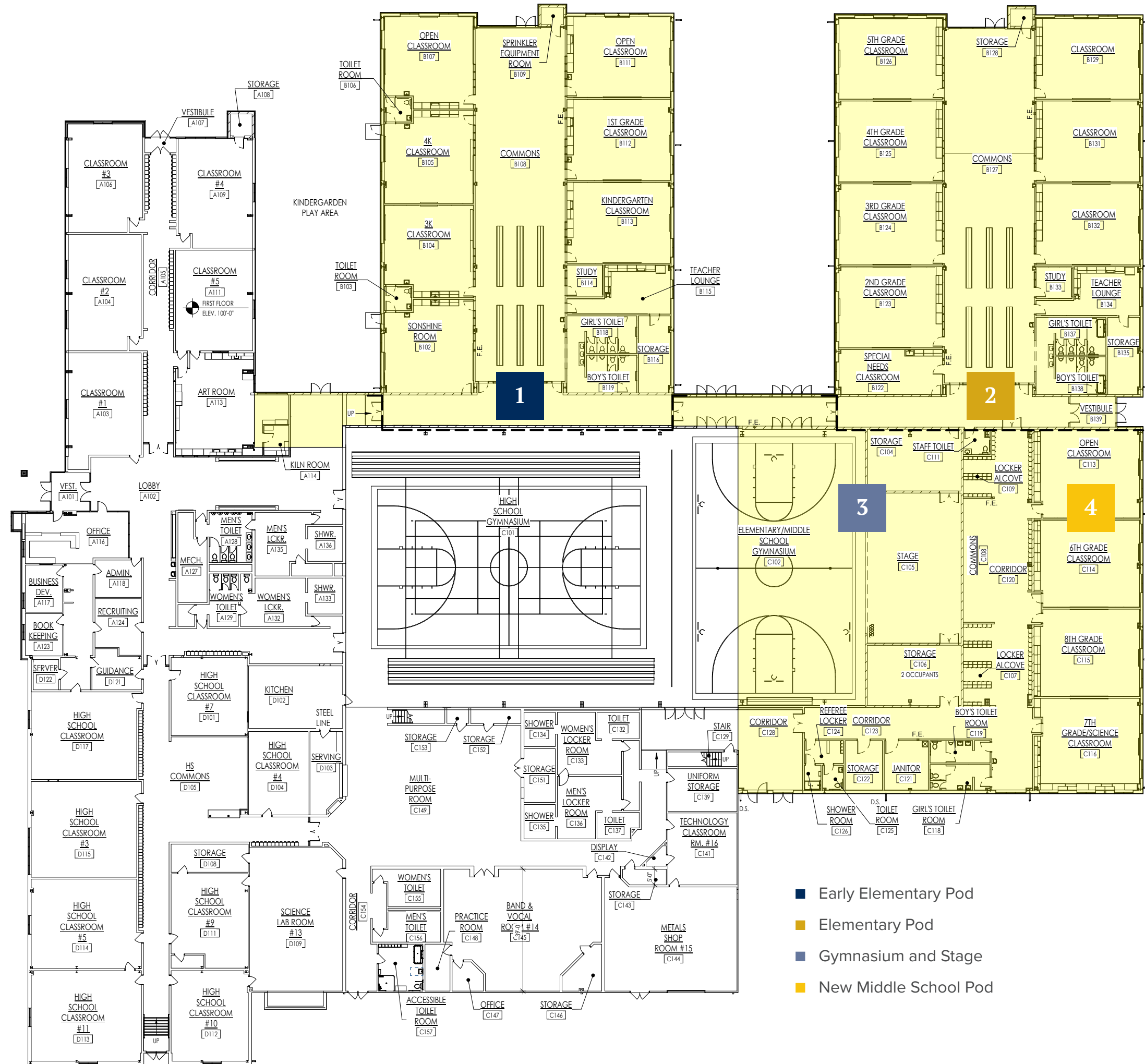

- Early Elementary Pod
- Elementary Pod
- Gymnasium and Stage
- New Middle School Pod

Early Elementary Pod

PK through 1st grade

Recognizing that students learn differently at different age levels, SCS looks forward to inviting our early elementary students into spaces that facilitate learning through creativity, exploration, and collaborative play.

The Early Elementary Pod will have separate playground space with age appropriate equipment. Community space will create opportunities for corporate worship, music and motion, and STEAM (science, technology, engineering, art, math). Early elementary students will be kept safe in the community pod, having access to their own cubbies, bathrooms, and water breaks. Small group work spaces will be used for a variety of learning centers, social engagement, and facilitated practice. Our extended care program will be housed in the early elementary pod for safe transitioning before, during, and after the learning day.



FEATURES

- Room to grow! Two homerooms per grade level
- Before/After Care designated space in house
- Access to developmentally appropriate playground
- Communal worship space
- Maker space for hands on learning



“Play is the highest form of research.”
—Albert Einstein

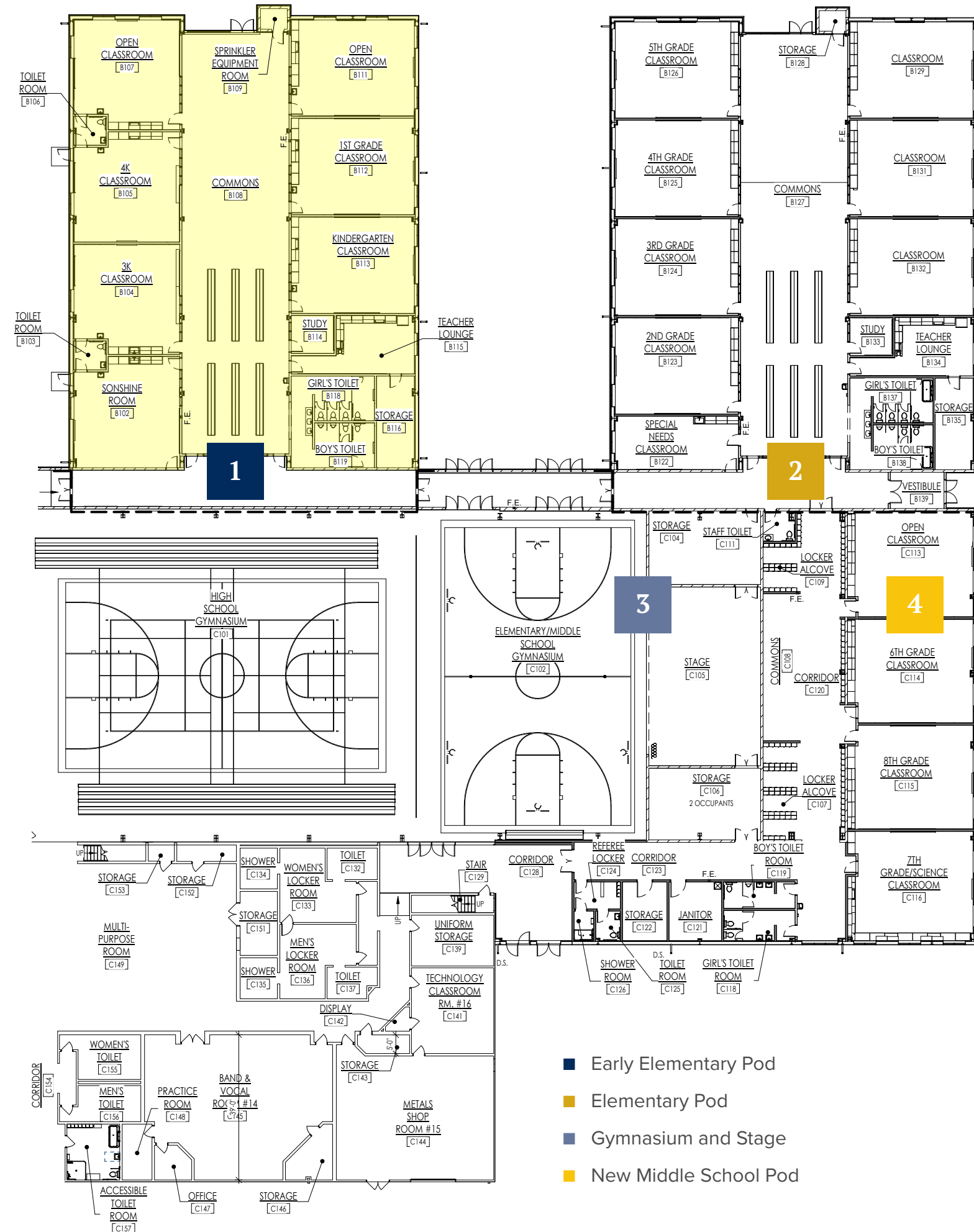

- Early Elementary Pod
- Elementary Pod
- Gymnasium and Stage
- New Middle School Pod

Elementary Pod

Grades 2 through 5

What will you see?

As you enter, you will see multiple areas that offer a variety of learning experiences. You will see a modern student library. You will find a designated space for STEAM projects related to science, technology, engineering, art, and math. There is a large area for groups to gather around reading, writing, and corporate worship. The possibilities are endless!

What will you experience?

This space allows for readers to meet in book clubs, spilling the learning out of the classroom and into the shared space. Team of science students will be brainstorming and carrying out lab investigations, designing solutions to problems. You will hear students from multiple grade levels gathering to praise and worship God together in chapels. There will be celebrations of writing and reading successes happening for all to experience. This space will allow multiple grade levels to grow academically, spiritually, and socially!

FEATURES

- Room to grow! Two homerooms per grade level
- Classroom collaboration – the space is designed to fit our innovative approach
- Designated space for special education
- Communal worship space
- Maker space for hands on learning



“An investment in knowledge pays the best interest.”
—Benjamin Franklin

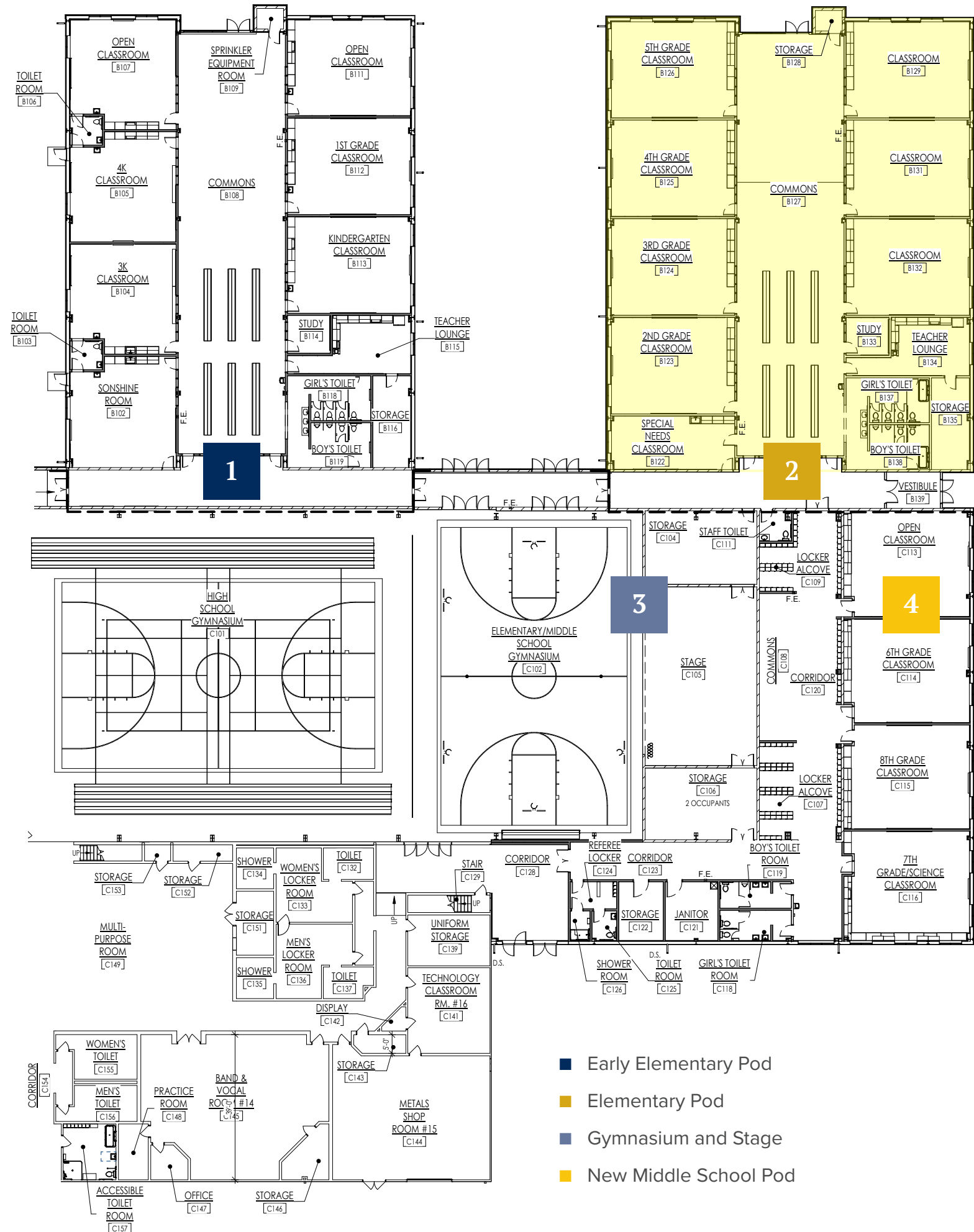

Gymnasium & Stage

An investment in athletics, arts, and worship for all SCS students

As our school population continues to grow, so does our need for physical exercise, team building, and exploration of student gifts and talents. Our added gym space will allow for multiple teams to practice and play games at the same time, expanding our athletic program opportunities. The added stage space will provide a home base for our weekly chapel team as well as designated performance space for our drama teams, forensics, music programs, and art shows. SCS is thrilled to expand the ability to showcase student talent.



FEATURES

- Accessible to all grades, P-12
- Additional gymnasium for volleyball and basketball teams, physical education program
- The first designated stage in the history of our school, allowing for improved dramatic performances and worship
- Ability to do all-school chapels in house at any time

Added space for physical exercise, team building, and exploration of student gifts and talents.

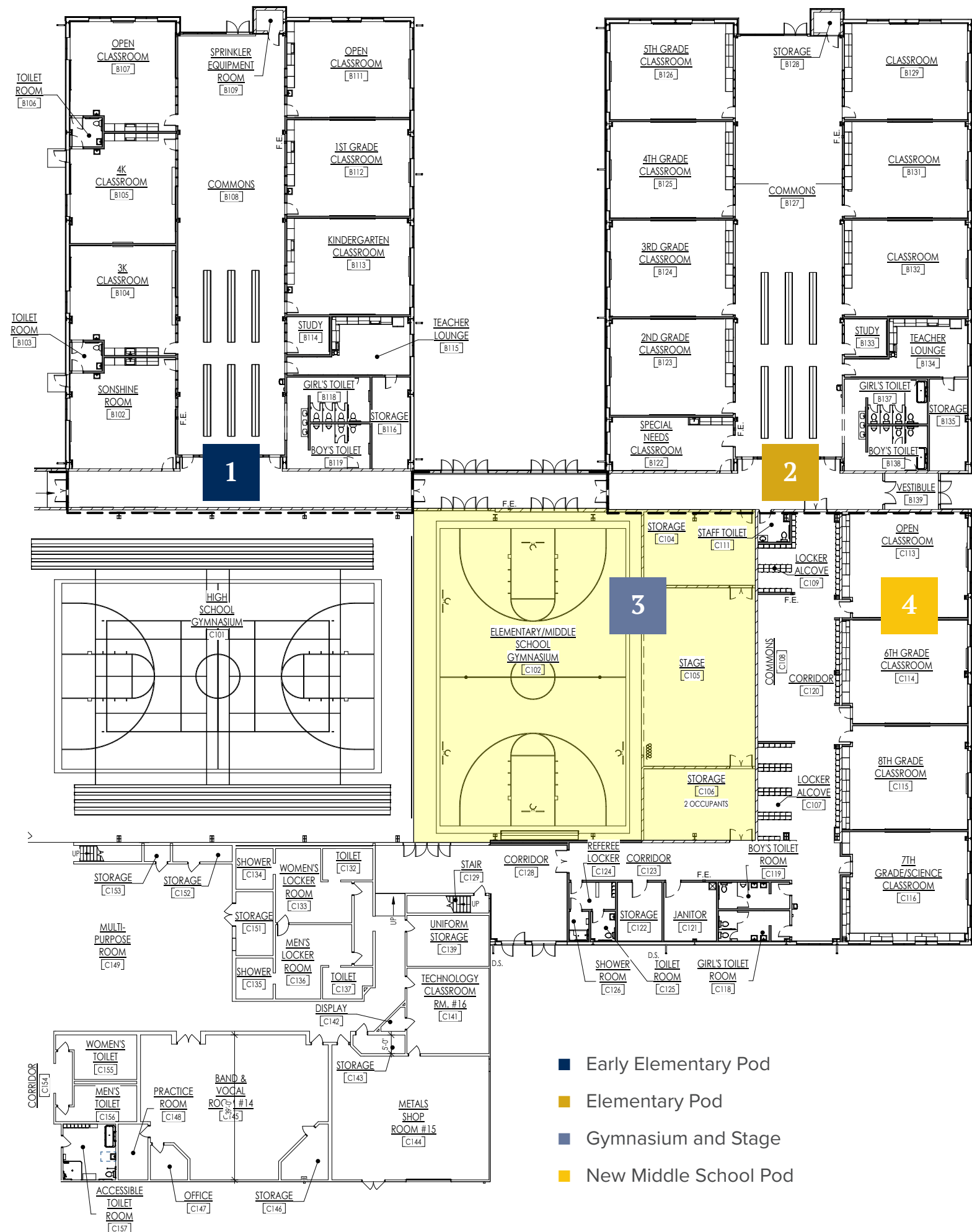

- Early Elementary Pod
- Elementary Pod
- Gymnasium and Stage
- New Middle School Pod

New Middle School

Grades 6 through 8

With the addition of a new middle school wing, SCS will be able to provide stellar learning and social space for our early adolescents.

As part of Phase 2 of the building project, a brand new middle school will create space for four homerooms, a spanish classroom, and intervention services. The commons area will allow students to gather for collaborative small group work, chapel planning, presentations, and middle school chapels. The middle school will have access to additional green space and hard surface space for outdoor activities and breaks.

FEATURES

- Phase 2 of the Building Hearts and Minds Campaign
- Footprint and shell will be completed in Phase 1
- Shell will be “filled in” as part of a second round of construction and fundraising

More learning and social space for our students is essential.



“Train up a child in the way he should go; even when he is old he will not depart from it.”
—Proverbs 22:6

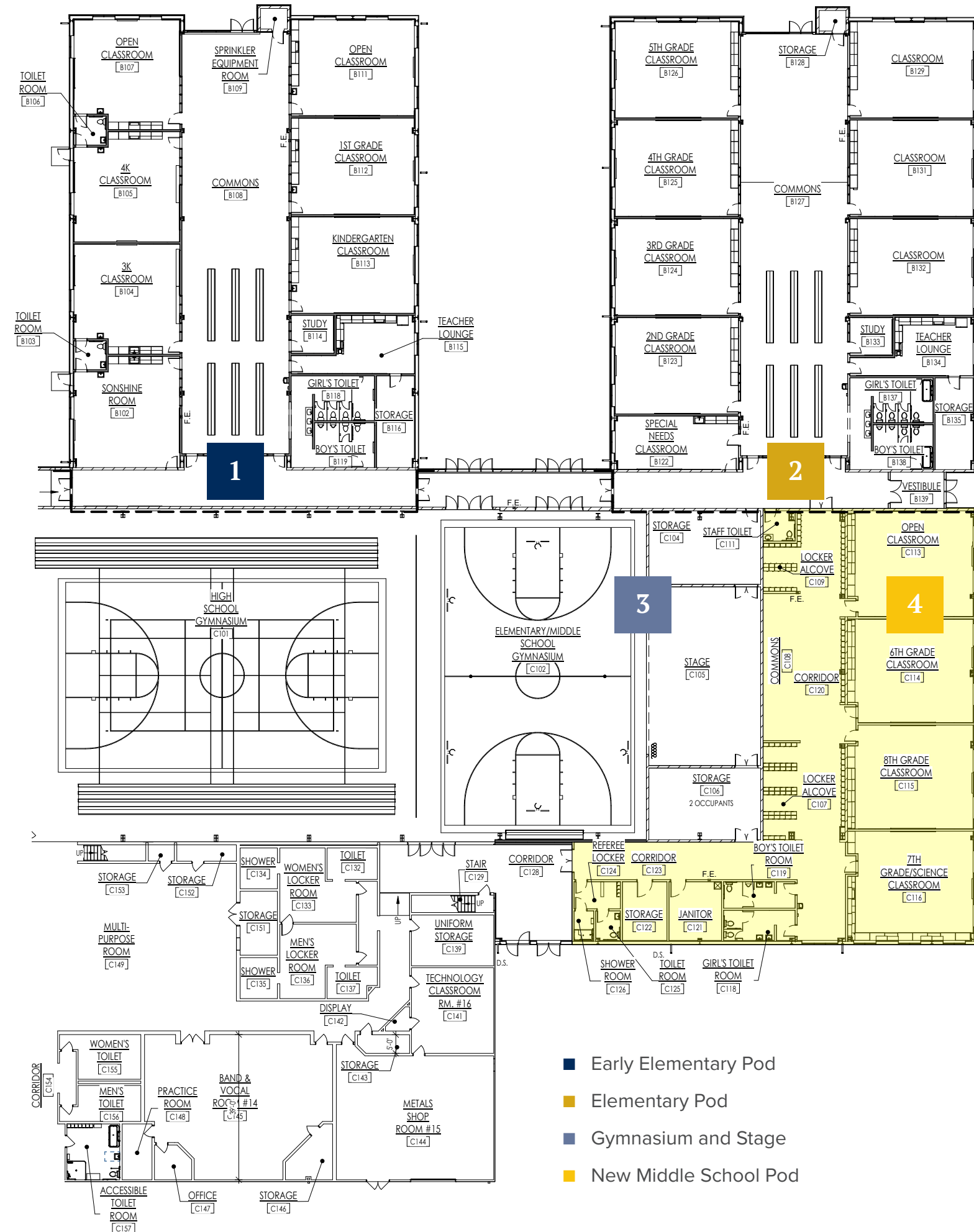



**SHEBOYGAN
CHRISTIAN
SCHOOL**



HOW TO GIVE

We want to make the invitation and next steps very clear to you, so that you can succeed in your important role as we work to succeed in ours. You can “dig deep” for Sheboygan Christian School by:

Praying

Pray that our building project would reach completion to serve each student within our walls with the powerful impact of a high-quality Christian education and environment.

Serving

Members of our broadest community can identify the gifts and abilities they can offer to this project and within our school walls long into the future.

Giving financially

EVERY MEMBER of our community, both near and far, can answer the call to “dig deep” and support SCS in whatever capacity they are able at this historic juncture to support, strengthen, and expand the presence and impact of SCS for generations to come. Please see pledge card insert for ideas and avenues to give in this way.

Building Hearts *and* Minds

An Unprecedented Project Requires Unprecedented Support

This is the biggest project in the history of Sheboygan Christian School. And we’re all in. We have campaign contributions from:

- 100% of the Capital Campaign Steering Committee
- 100% of the Board of Trustees
- 100% of the Administration
- 100% of the Faculty & Staff

This is the public phase of the Capital Campaign. We’re hoping to raise \$1.5 Million through this phase – the biggest community fundraising goal in the history of our school.

While this is a huge goal, it’s also eminently doable. In fact, if 100% of the people on this mailing list contributed only \$1-a-day, we would have enough to fund the entire campaign.

We’re all in. Are you?

\$1-a-day commitment over the next three years from everyone on this mailing list exceeds this phase’s \$1.5 Million goal! \$3-a-day over the same period would cover the entire cost of the project!

Please prayerfully consider contributing to this capital campaign. It is our prayer that our community steps up in unprecedented ways to help us lead this school into a bright future for generations to come.



“Each of you should use whatever gift you have received to serve others, as faithful stewards of God’s grace in its various forms.” —1 Peter 4:10



SHEBOYGAN CHRISTIAN S C H O O L

High School Campus | 929 Greenfield Avenue, Sheboygan, WI 53081

Elementary & Middle School Campus | 418 Geele Avenue, Sheboygan, WI 53083

Address Service Requested



Stay Connected with SCS



Like us on Facebook

facebook.com/sheboyganchristian



Follow us on Instagram

[@sheboyganchristian](https://instagram.com/sheboyganchristian)

www.sheboyganchristian.com